

SEWAGE

Range Vortex SF

Submersible
Pump for
Sewage Water

KEY ADVANTAGES OF A VORTEX PUMP:

Incolmatage : The vortex impeller creates a vortex that leads to most solids without contact with the turbine and the fibrous materials are repelled and can not hold on to the turbine.

Minimum wear + consistent performance: The Vortex pump wear is very low because most of the solids pumped passes through the volute without touching the turbine. The yield remains constant over a long period.

Low maintenance + no adjustment: The position of the wheel back in the volute eliminates the risk of blockage and sudden loss of performance. No adjustment is necessary and the cost of maintenance and operation are low and constant.

..... ■ Vortex SF : Horizontal outlet

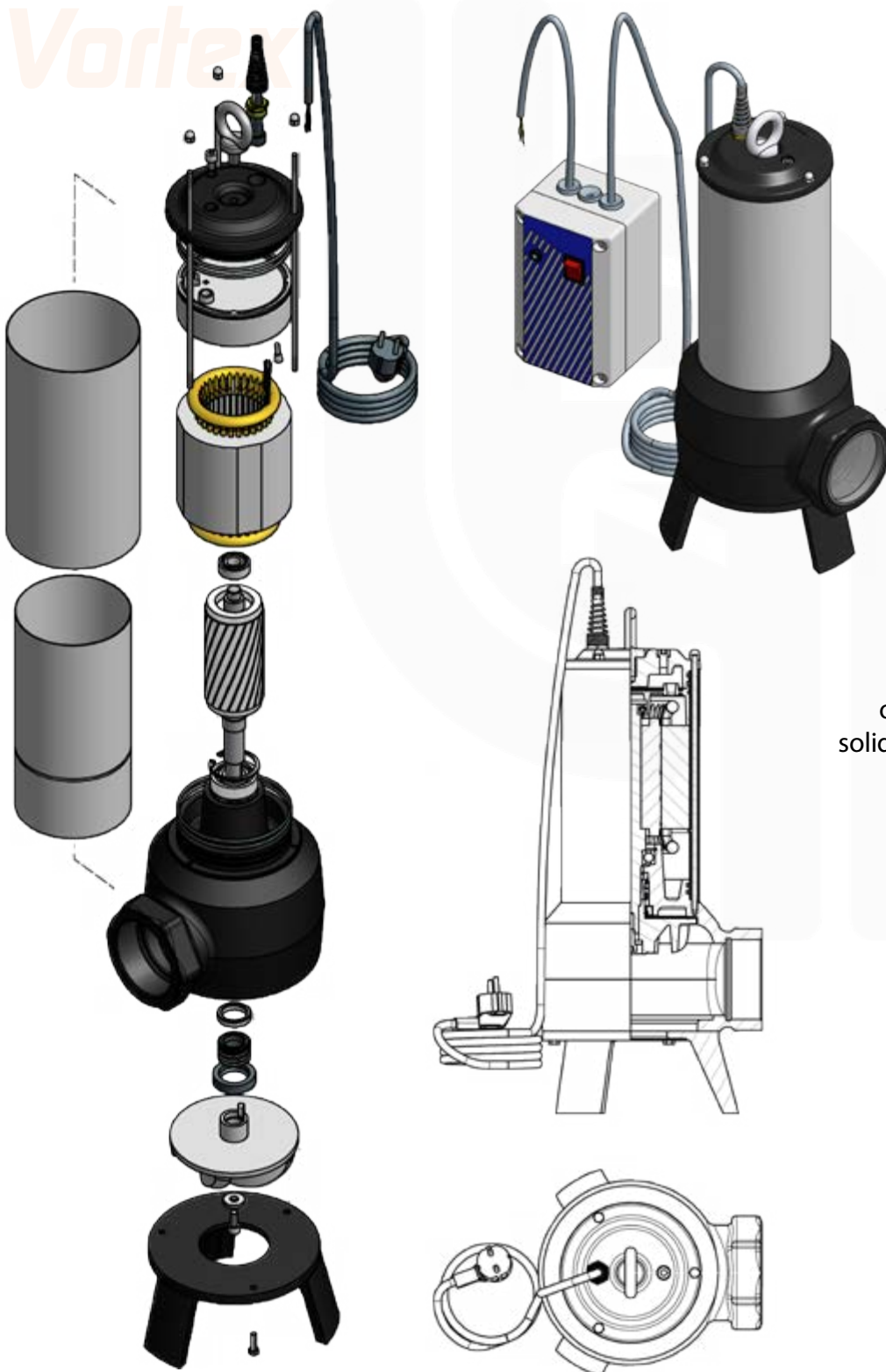

The range **Vortex SF** is designed for pumping of sewage with suspended solids, it is ideal for installation with guide rain.

USE :

Water loaded with suspended matter
 All wastewater from homes, including toilets from 80 mm to pass
 Front outlet is ideal for installations with guide rail
 Immersion depth of 10 m

FEATURES :

Protection box in monophasic version.
 Motor casing in stainless steel, volute pump head and impeller in cast iron, stainless steel shaft. Engine oil bath class F, 10 m cable, Double seals, lip seals and mechanical seal **SIC-SIC**
 Single-phase models with or without float float (type A)



SEWAGE
Vortex SF

**Submersible
 Pump for
 Sewage Water**

Horizontal outlet

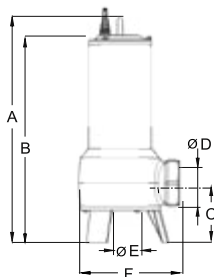
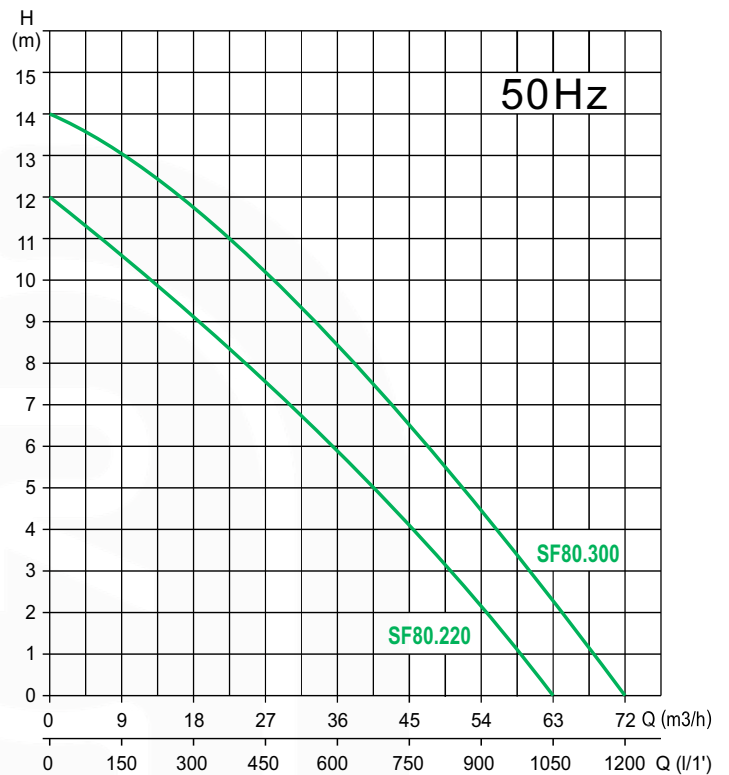

Type	Dimensions (mm)						Weight Kg
	A	B	C	ø D	ø E (passage)	F	
SF 80.150	520	485	145	3"	80	240	28
SF 80.220	535	500					30

Type	Power		Motor			Passage ø mm	Connectin DN	H (max) m	Debit (max) m³/h	Code	
	kW	CV	1~ A	3~ μF	3~ A					1x230v (.1M)	3x400v (.3)
SF 80.220	2,2	3	12,2	50	5	80	3	12	63	01010971	01010973
SF 80.300	3	4	-	-	8			14	72	---	01010974

Power cable: 10 m neoprene

SEWAGE

Range Vortex SV

Submersible
Pump for
Sewage Water

KEY ADVANTAGES OF A VORTEX PUMP:

Incolmatage : The vortex impeller creates a vortex that leads to most solids without contact with the turbine and the fibrous materials are repelled and can not hold on to the turbine.

Minimum wear + consistent performance: The Vortex pump wear is very low because most of the solids pumped passes through the volute without touching the turbine. The yield remains constant over a long period.

Low maintenance + no adjustment: The position of the wheel back in the volute eliminates the risk of blockage and sudden loss of performance. No adjustment is necessary and the cost of maintenance and operation are low and constant.

..... ■ Vortex SV : Horizontal outlet

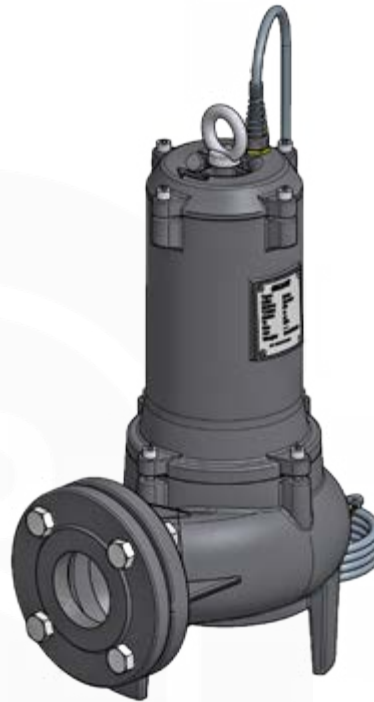

The range **Vortex SF** is designed for pumping of sewage with suspended solids, it is ideal for installation with guide rain.

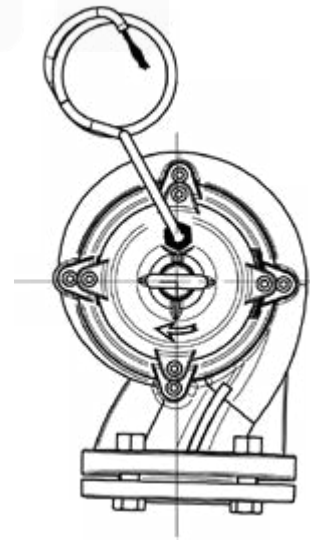
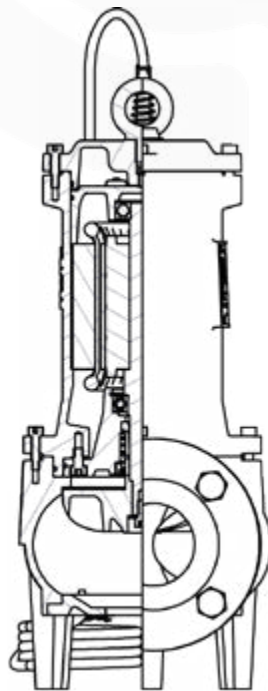

USE :

Water loaded with suspended matter
 All wastewater from homes, including toilets from 65 mm to pass
 Front outlet is ideal for installations with guide rail
 Immersion depth of 10 m

FEATURES :

Protection box in monophasic version.
 Motor casing and volute pump head and impeller in cast iron, stainless steel shaft. Engine oil bath class F, 10 m cable, Double seals, lip seals and mechanical seal **SIC-SIC**



SEWAGE
Vortex SV

**Submersible
 Pump for
 Sewage Water**

Horizontal outlet

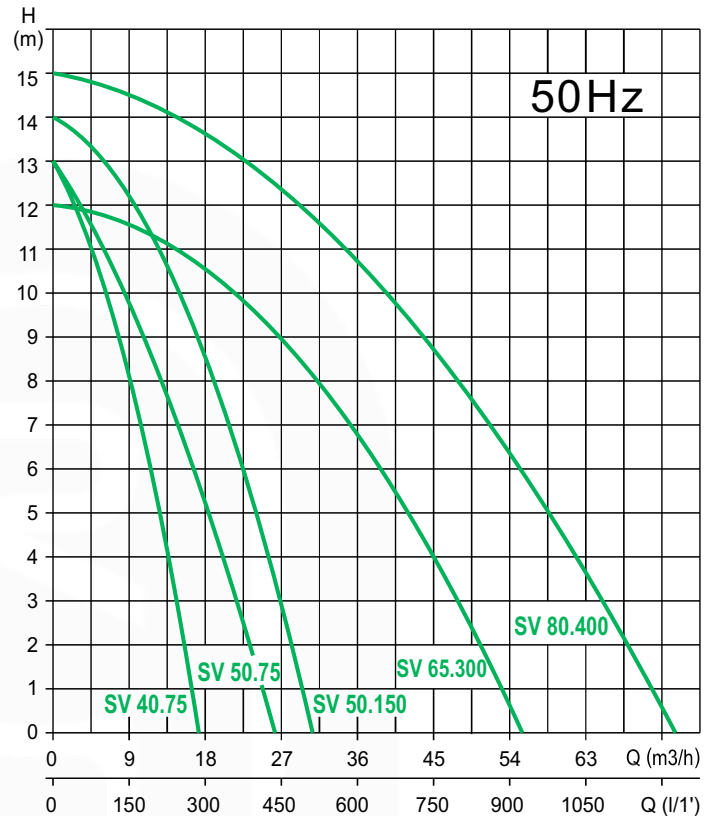
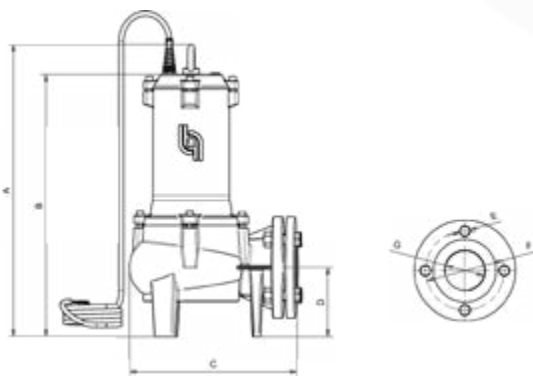

Type	Dimensions (mm)						G	Weight Kg
	A	B	C	D	ø E	ø F		
SV 40.75	443	387	203	84	11	102	1 1/2"	22
SV 50.75	466	410	208	98			2"	23
SV 50.150	492,5	438,5	252	102	13	115	2"	34
SV 65.300	536	481	310	127				2 1/2"
SV 80.400	598	544	309	150,5	18	145	3"	60

Type	Power		Motor			Dna	Dnc	H (max) m	Debit (max) m³/h	Code		
	kW	CV	1~ A	μF	3~ A					1x230v (.1M)	1x230v (.1A)	3x400v (.3)
SV 40.75	0,75	1	4,8	20	1,4	DN40	DN40	13	16	01011181	01011180	01011182
SV 50.75			7,2	20	2,8	DN50	DN50	13	26	01011184	01011183	01011185
SV 50.150	1,5	2	8,6	40	3			14	31	01011187	01011186	01011188
SV 65.300	3	4	-	-	4,8	DN65	DN65	12	54	---	---	01011066
SV 80.400	4	5,5	-	-	8,8	DN80	DN80	15	70	---	---	01011177

Power cable: 10 m neoprene - Type A: model with float switch